

Straight Talk from 3D CAD Users

Hear What Designers Are Saying about Pro/ENGINEER



DID YOU KNOW

"Moving from 2D design with AutoCAD® to 3D design with Pro/ENGINEER sped up our development times by 80%."

David Barbour works as Technical Manager for Re-Process Technologies in Brakpan, South Africa. The company is a leading manufacturer of mining equipment, including equipment for processing, drying (gas & electric), milling, pelletizing, blending air and sieve classification, and much more. The company produces complete turnkey systems, along with welding and quality consultancy, welding audits (by International Welding Engineer), and now 3D design. Re-Process moved from 2D to 3D product development in 2008.

Although Mr. Barbour has more than 10 years of professional experience as a designer, he had never used 3D CAD systems until 2008. After introducing Pro/ENGINEER into his company, he attended a one-week training class conducted by a local PTC software reseller in South Africa, which gave him a quick start into the world of 3D.

"The software interface is clearly structured, and my becoming familiar with the functionality was not a problem at all," he reports.



David Barbour, Technical Manager

Together with his brother, Adrian Barbour, he manages Re-Process Technologies in Brakpan, South Africa.

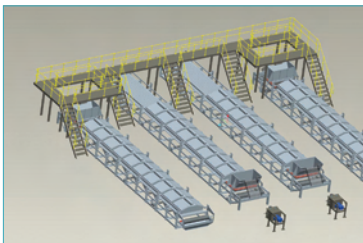

109Kw Drying & Processing Assembly, fully designed in Pro/ENGINEER.

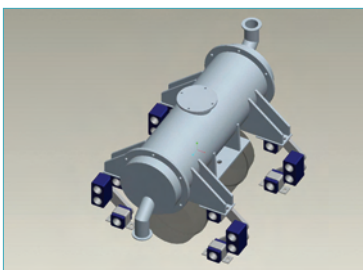

10 Liter Rod Mill for Crushing/Milling Products.

Why Pro/ENGINEER is So Effective

"We made the business decision to migrate to 3D to stay competitive in today's tough market. We thoroughly evaluated the major tools on the market and finally decided on Pro/ENGINEER. What influenced our decision was the fact that the basic Pro/ENGINEER Foundation XE package includes so much special functionality at a relatively low price.

We started primarily working with solids and sheet metal, but have now included structural analysis with Pro/ENGINEER Mechanica®. With Pro/ENGINEER, you can handle all tasks with one tool, and when your requirements change, you can easily extend your environment and everything works smoothly together – no need to reach out to third-party vendors and learn yet another application.

Also, we were looking for a system that could handle our very large assemblies, but remain easy to use – after all, the move from 2D to 3D should be a step forward for us, and we could not run the risk of development delays caused by a complicated system integration. In this respect, Pro/ENGINEER has totally met our expectations. The integration went very smoothly, and we find Pro/ENGINEER much easier to use than our old AutoCAD 2D package.

The migration to 3D product development has been an important step for me and my company. From the simple fact of being able to show a customer something in a 3D environment – so that he can easily visualise what we'll be delivering, to the fact that our product development times have been drastically reduced, Pro/ENGINEER is giving us all we need to stay competitive in the process engineering sector."